



HGUV SERIES UV SYSTEM

Material of construction

Stainless Steel 304 or 316L

Inlet / Outlet

DN or others

Type of UV Light

254 nm wave length

LIGHT SOURCES UV light (made in USA)

UV Light Life

HGUV-1 TO HGUV-8 : 9000 hours

HGUV-9 TO HGUV-10 : 13000 hours

Pressure

Maximum 0.8 Mpa

Bacteria Killing Rate

99.9%

Power

Single Phase 220V/50Hz

Come With

Light Function Indication

Light & Sound Alarm System

Hours Counter

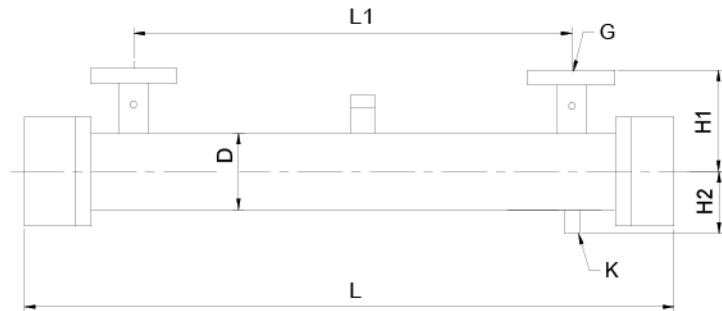

DIMENSION

Model	L	L1	H1	H2	D	G	K
HGUV-1	980	655	180	105	159	DN80	1"
HGUV-2	980	635	180	105	159	DN100	1"
HGUV-3	980	635	184	110	168	DN100	1"
HGUV-4	980	635	184	110	168	DN100	1"
HGUV-5	980	610	210	135	219	DN125	1"
HGUV-6	980	585	210	135	219	DN150	1"
HGUV-7	980	585	210	135	219	DN150	1"
HGUV-8	980	585	237	162	273	DN150	1"
HGUV-9	1800	1390	210	135	219	DN150	1"
HGUV-10	1800	1330	237	162	273	DN200	1"

Model	Flow Rate (GPM)	Flow Rate (m3/h)	Power (W)	No. of UV Light	Inlet & Outlet	Quartz Sleeve (mm)	Quartz Type
HGUV-1	132	30	400	5	DN80	900	Double End
HGUV-2	154	35	475	6	DN100	900	Double End
HGUV-3	176	40	550	7	DN100	900	Double End
HGUV-4	198	45	625	8	DN100	900	Double End
HGUV-5	220	50	725	9	DN125	900	Double End
HGUV-6	264	60	875	11	DN150	900	Double End
HGUV-7	352	80	1025	13	DN150	900	Double End
HGUV-8	440	100	1175	15	DN150	900	Double End
HGUV-9	550	125	1420	4	DN150	1700	Double End
HGUV-10	660	150	2090	6	DN200	1700	Double End

HGUV - 8 - 2 - N - 304 - A

Series	Model	Connections	Connection Type	Material	Type
HGUV	1 to 10	1 = 1" 2 = 2"	N = NPT J = JIS D = DIN B = BSP AF = ANSI Flange JF = JIS Flange DF = DIN Flange BF = BS Flange	304 = SUS 304 316L = SUS 316L	Nil = Normal M = Manual Clean A = Auto Clean